

Turn-Key Office Space

Now Leasing

Building one of a kind office environments that inspire creativity and maximize productivity.

📍 2600 25th St. E Minneapolis, MN

🏠 9,400 total SF

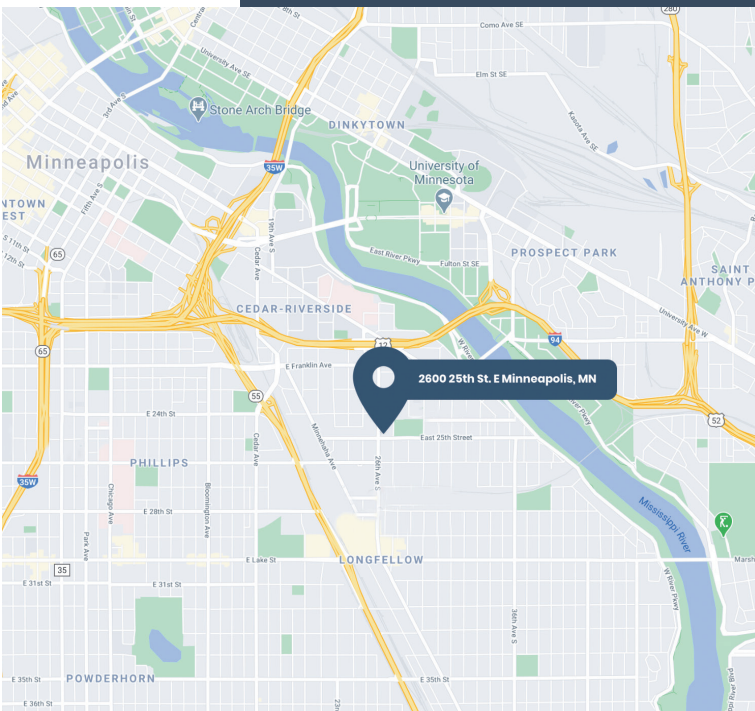

Overview

Great curb appeal with 9,400 sq. ft. on the 2nd level. The space can be leased entirely or be separated. Easy access & high traffic counts. On a major bus line. Open parking behind building. Additional street parking is available. New 60-mil EPDM synthetic roof membrane system and new HVAC system. Property zone I-1, light industrial.



Highlights

- Turn-key office with high quality finishes
- Multiple offices and conference rooms
- Excellent South Minneapolis urban location
- Great curb appeal
- Easy access to Hwy 55 (Hiawatha)
- High traffic counts
- Located on major bus line
- Off street parking available
- Walking distance to several restaurants, coffee shops & Mathews Park

Year Built 1970

Lot 0.82 acres

Offices 39

Conference 3

Reception 2

Elevator 1



For more information:
www.urbanmn.com

✉ chad@urbanmn.com
 ☎ (612) 554 - 8423

URBAN INDUSTRIES

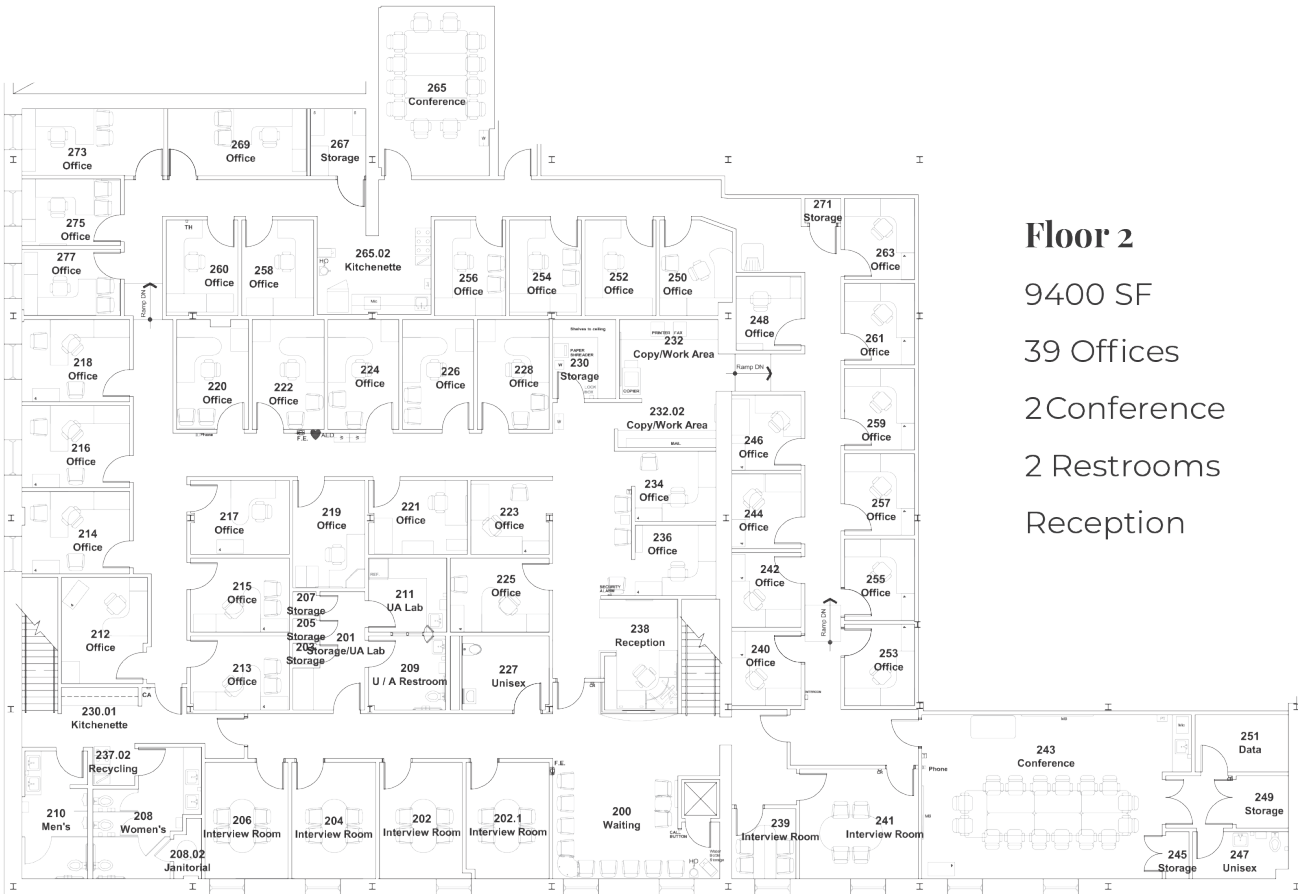

Floor 2

9400 SF

39 Offices

2 Conference

2 Restrooms

Reception

For more information:
www.urbanmn.com

✉ chad@urbanmn.com
 ☎ (612) 554 - 8423

URBAN INDUSTRIES